

46-540 R and R tie rod ends

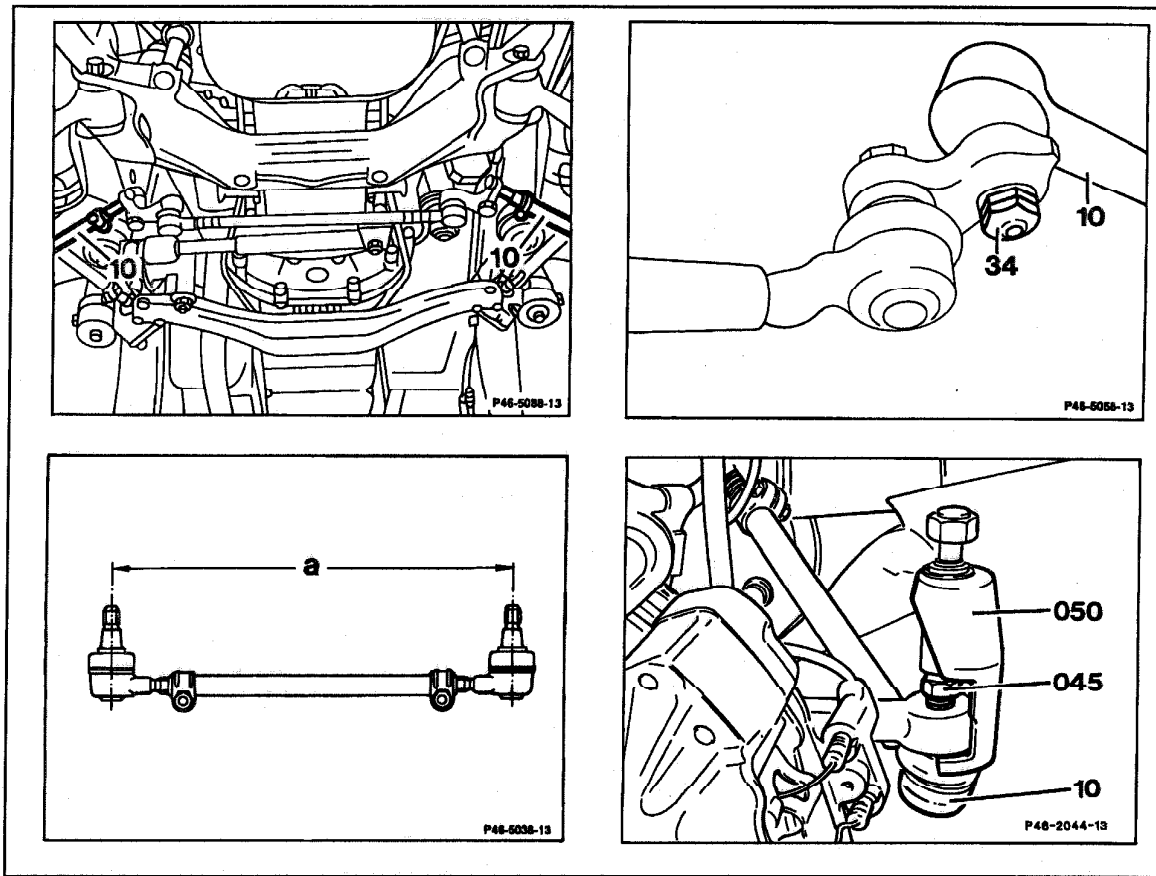

P46-5060-57

Self-locking nut (34) screw off, screw on and replace, 35 Nm.

Tie rod ball joint (10) screw off thrust piece (045) 201 589 05 63 00, screw on and press off with puller (050) 124 589 01 33 00. Completely remove all grease on ball bolts as well as tapered seats in idler arms, then press ball bolts tightly into taper in idler arm.

Note

Hold ball bolt with Allen wrench, if required.

- Tie rod (10) check for damage, deformation and wear on ball joints (see Note).
 Observe color code, length "a" and installation position (see Technical data 46-050).
- Toe-in check after installing tie rod (10), adjust, if required (40-320).

Approved grease for ball joint

Multi-purpose grease

Refer to factory approved service products list ¹⁾

¹⁾ Supplied with owner's literature or available through your local authorized Mercedes-Benz Dealer.

Special tools

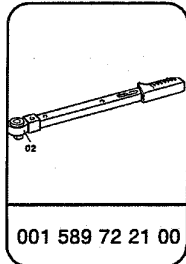
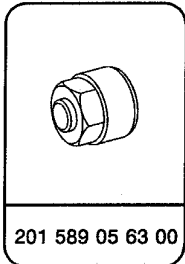
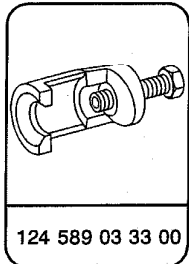

Note

Check tie rod joint. If clearance is too high, replace affected tie rod head. Check rubber boot (36). If rubber boot on used joint is damaged, completely replace affected joint.

If rubber boot (36) is damaged during removal of the tie rods, it is sufficient to replace the rubber boot (36) only (46-560).

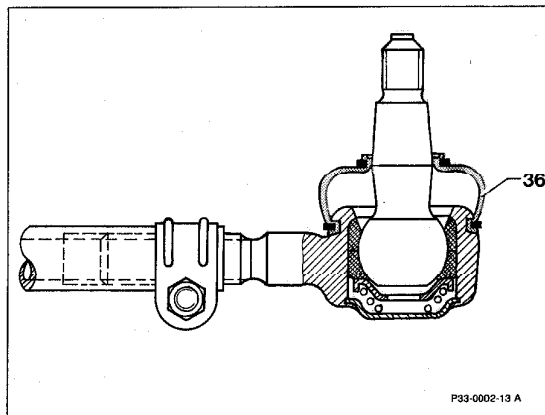

P33-0002-13A